

FORD EXPLORER SPORT TRAC INSTRUCTIONS

Ford Sport Tracs, because of their unique nature, require additional assembly procedures to install the side rails. A set of support brackets and hardware have been included with your TruXedo® kit in place of the clamp assemblies used on standard pickup boxes. These have been especially designed to fit your Sport Trac composite box.

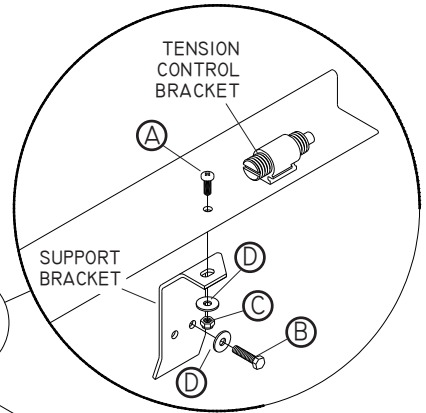
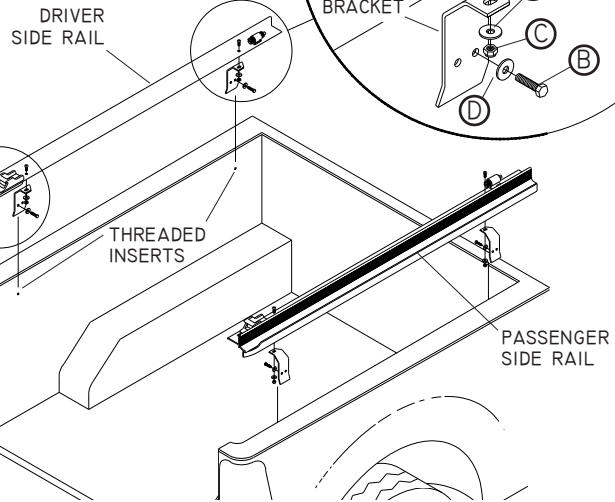
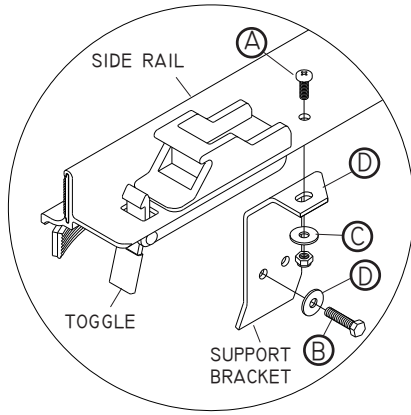

Hardware	
(A)	Pan Hd Cap Screw, 1/4" x 3/4"
(B)	Cap Screw w/Locking Patch, m6x1 x 25mm
(C)	Nylon Lock Nut, 1/4"
(D)	Flat Washer, 1/4"

Note: Threaded inserts are built in to your Sport Trac composite box

STEP 1: Align rear hole in support bracket with threaded insert in composite box near tailgate. Insert screw **B** through washer **D** and hole in bracket. Finger tighten into composite box.

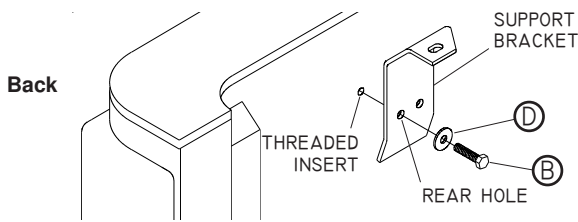

STEP 2: Align front hole on support bracket with threaded insert at front of composite box. Insert screw **B** through washer **D** and hole in bracket. Finger tighten into composite box.

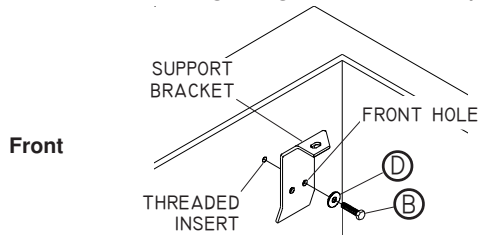

STEP 3: Fasten side rails to support brackets through pre-drilled holes in side rails with screws **A**, washers **D** and nuts **C**.

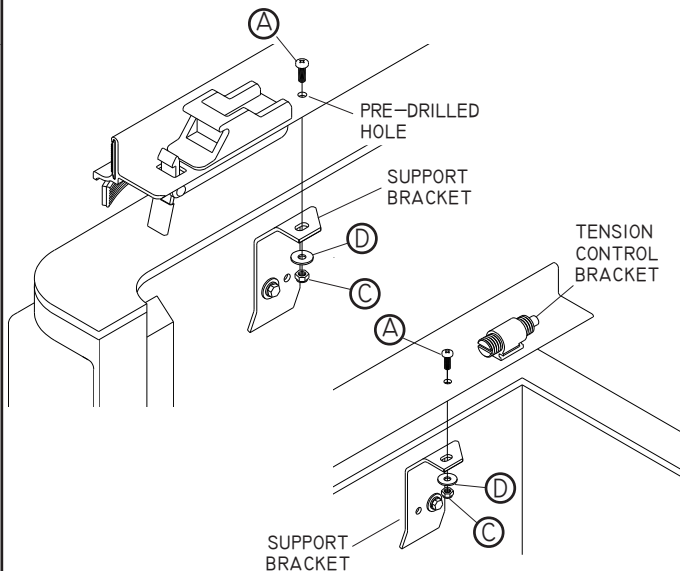

STEP 4: Tighten all screws and nuts securely.

CAUTION Tighten screws and nuts on side rails before driving vehicle.

TruXedo, Inc.

P.O. Box 1078, 2209 Kellen Gross Dr., Yankton, South Dakota 57078

Call Toll Free: 1-877-TRUXEDO (1-877-878-9336) Fax: (605) 664-9304 Visit Us Online: <http://www.truxedo.com> P/N 1113672 Rev. C

TRUXEDO Inc.